



HP ProCurve Switch 4100 Series Fan Tray Replacement Instructions

This booklet describes the procedures to replace the fan tray in your HP ProCurve Switch 4100 Series devices. Separate procedures are provided for the Switch 4104, and Switch 4108 chassis. The procedures are slightly different for these different sized chassis.



Fan Tray Installation Precautions

Warnings

- **Make sure that all AC power is disconnected from the switch before starting the procedures described in this guide. Do not reconnect the power until the switch is completely reassembled and cover plates are replaced on any open module slots or power supply bays.**
- **If your switch is rack mounted, make sure that the rack is not going to tip over as you complete these procedures. If the switch is difficult to reach, remove it from the rack or other mounting location before proceeding.**

Cautions

- Attach a properly grounded ESD wrist strap to your wrist when handling the switch modules, the fan tray, and the fan tray connector. Do not touch the components or edge connectors on any printed circuit boards, or the pins on any connectors. Otherwise, damage due to static discharge could occur.
- Refer to the installation guides that came with your switch and switch power supply for precautions on proper handling and installation of the switch and power supplies. For copies of the installation guides, visit the HP Procurve web site at <http://www.hp.com/go/hpprocurve>.

© Copyright 2003 Hewlett-Packard
Development Company, L.P.
The information contained herein is
subject to change without notice.

Part Number: 5990-6001
Edition 1, July 2003
Printed in Singapore



Removal and Replacement Procedures (Switch 4104)

1. Disconnect power and remove power supplies and cover plates.
2. Disconnect the fan cable connector from the backplane and remove the two screws securing the fan tray.

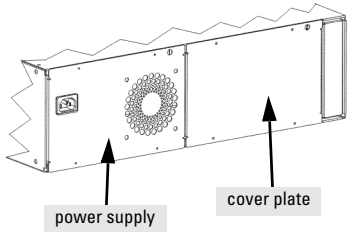

Loosen the captive screws holding the power supply and remove the screws in the cover plate.

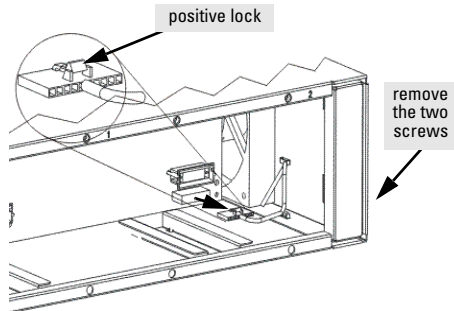

Caution: This connector has a positive lock. Be sure to depress the lock to remove the connector and pull straight out to avoid damaging the pins on the backplane.

3. Remove the old tray assembly.

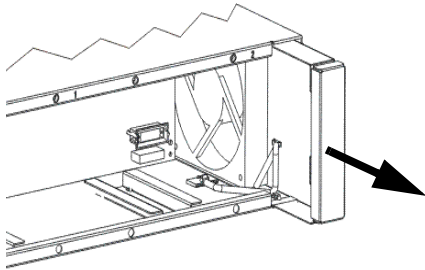

4. Install the new tray assembly.

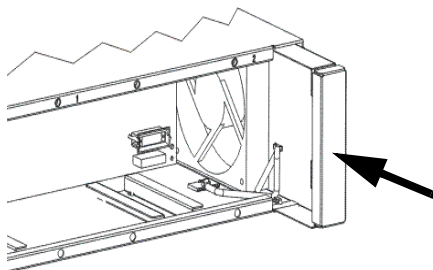

5. Connect the fan cable connector to the backplane and re-install the two screws securing the fan tray.

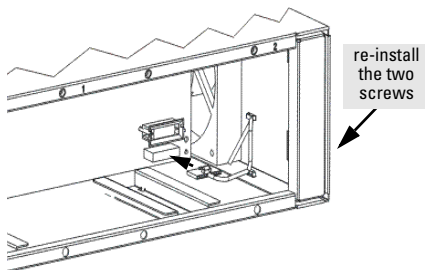

Caution: Avoid damage to the pins on the backplane connector by pushing the cable connector straight in.

6. Re-install power supplies and cover plates, and re-connect AC power.

7. Verify that the new fans are operating correctly:

- the fans should be operating
- the switch Power LED should be on
- the switch Fault and Fan Status LEDs should be on solidly and not flashing

Removal and Replacement Procedures (Switch 4108)

1. Disconnect power and remove power supplies and cover plates.
2. Disconnect the fan cable connector from the backplane and remove the two screws securing the fan tray.

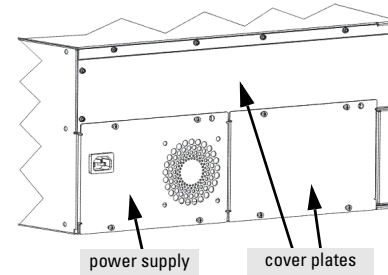

Loosen captive screws holding the power supply and remove screws in cover plates.

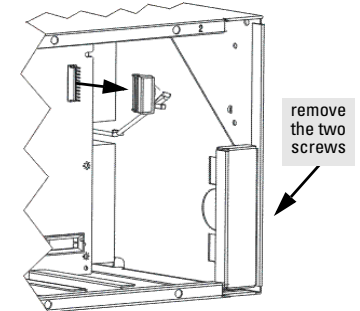

Caution: Avoid damage to the pins on the backplane connector by pulling the cable connector straight out.

3. Remove the old tray assembly.

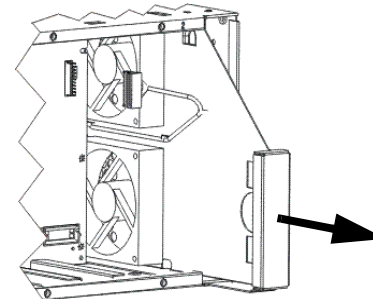

4. Install the new tray assembly.

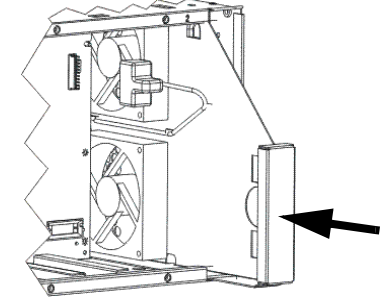

5. Connect the fan cable connector to the backplane and re-install the two screws securing the fan tray.

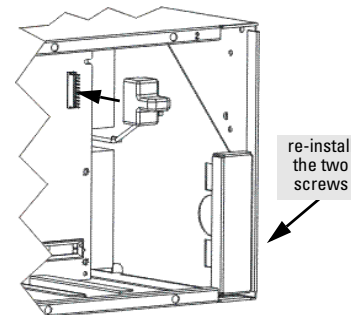

Caution: Avoid damage to the pins on the backplane connector by pushing the cable connector straight in.

6. Re-install power supplies and cover plates, and re-connect AC power.

7. Verify that the new fans are operating correctly:

- the fans should be operating
- the switch Power LED should be on
- the switch Fault and Fan Status LEDs should be on solidly and not flashing